

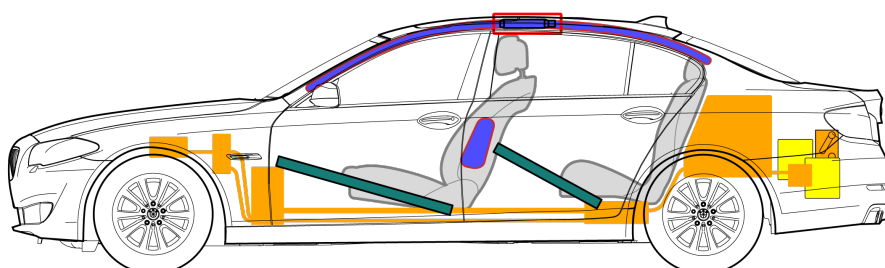

BMW 5 Series F18 PHEV

Saloon
from 12/2014

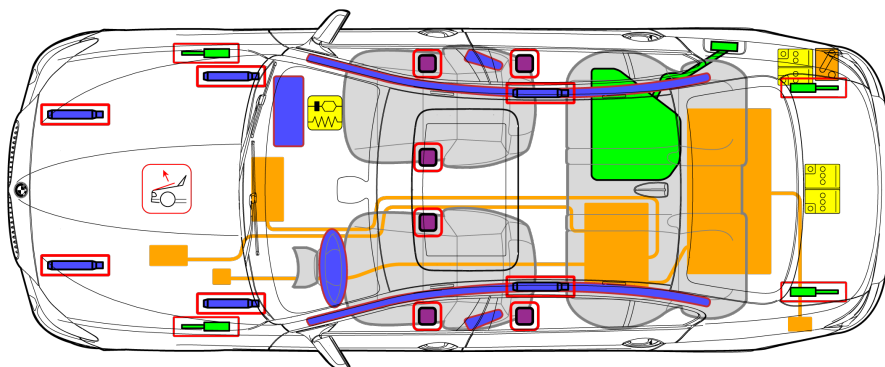

Legend

	Airbag		Stored gas inflator		Seat belt pretensioner		SRS control unit		Pedestrian protection active system
	Automatic rollover protection system		Gas strut / Preloaded spring		High strength zone		Zone requiring special attention		High voltage disconnect (cutting solution)
	Battery low voltage		Ultra capacitor, low voltage		Fuel tank		Gas tank		Safety valve
	High voltage battery pack		High voltage power cable / component		High voltage disconnect		Fuse box disabling high voltage system		Ultra capacitor, high voltage

This overview shows the maximum range of equipment of the vehicle

ID no.	Version no.	Version date	Page
WBV-F18 PHEV	1	11/2014	01

Important: For more information see rescue manual.

© 2015 BMW AG Munich, Germany

Identifying features and details

WARNING

High-voltage system.

The high-voltage system carries high-voltage currents. Fatal electric shock hazard!

- Do not touch the high-voltage components.
- Observe the following identifying features for high-voltage vehicles.

"eDrive" labelling on side panel and door sill cover strip, charging socket in rear left bumper, labelling on tailgate



Secure the vehicle to prevent it from rolling away

Press the "P" button.



Pull the switch for the electric parking brake upward.



Deactivate the drive and high-voltage system (set to de-energised condition) - airbag not deployed

(Ignition and low-voltage batteries accessible)

i NOTE

In case of accidents resulting in airbag deployment, the high-voltage system is automatically deactivated (de-energised).

i NOTE

The negative terminals of the low-voltage batteries and the high-voltage disconnect must be disconnected in all cases.

If the engine is running or displays are active in the instrument cluster, press the "START STOP" button to switch off the ignition.



Open the tailgate and remove the service flap (1) on the right-hand side.

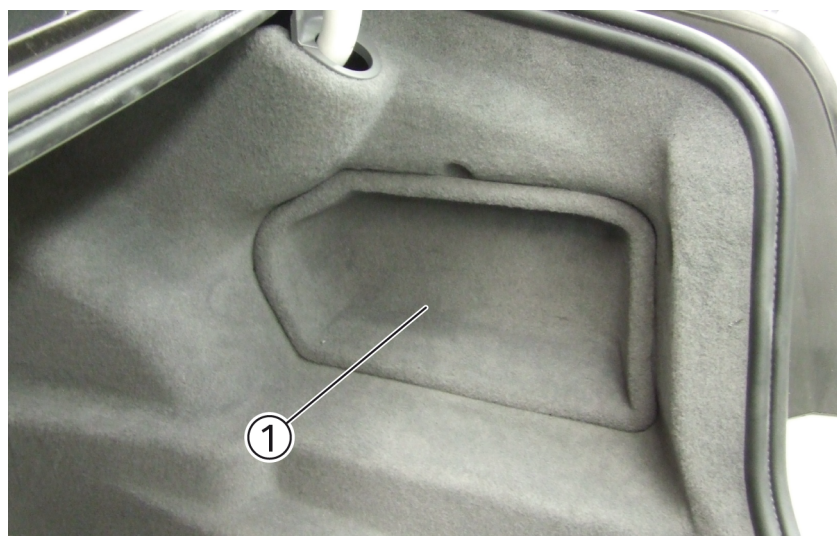

Unlock the plug (1) for high-voltage disconnect (2) and pull apart in the direction of the arrow.

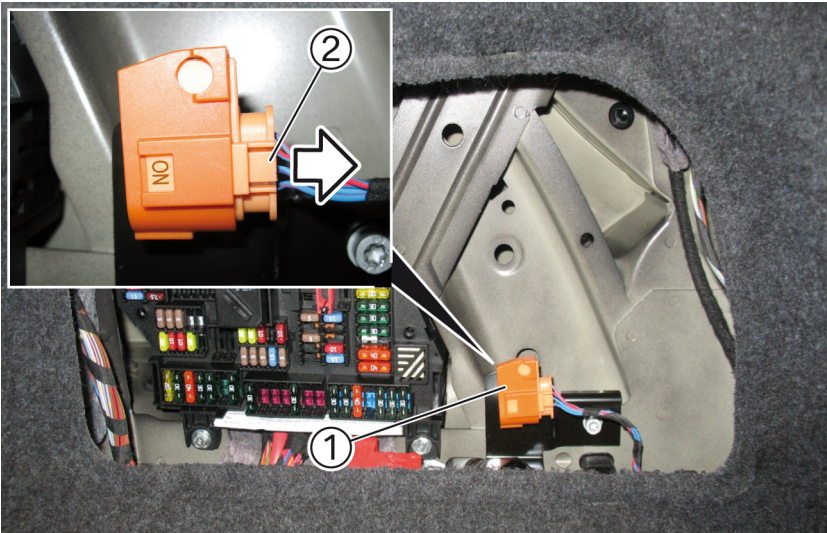

The high-voltage system is deactivated when the hole (1) is clear all the way through and the word "OFF" can be seen on the plug.

To prevent inadvertent activation of the high-voltage system, a padlock can be installed through the open hole (1), for example!

NOTE: The plug connection cannot be completely separated.

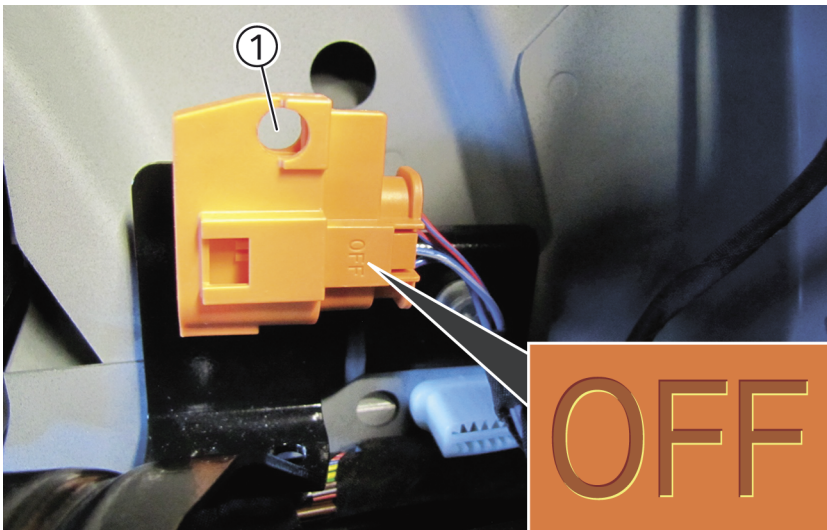

Loosen the nut and pull off battery negative cable (1) upwards.

Cover the battery negative terminal to avoid contact with the battery negative cable.

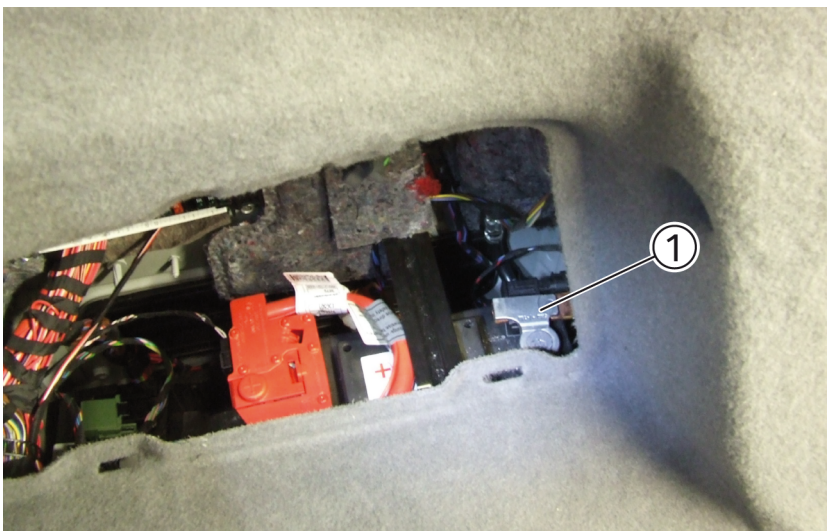

Fold up the luggage compartment floor lining (1).

Release plastic nuts (2) and remove luggage compartment floor trim panel (1).

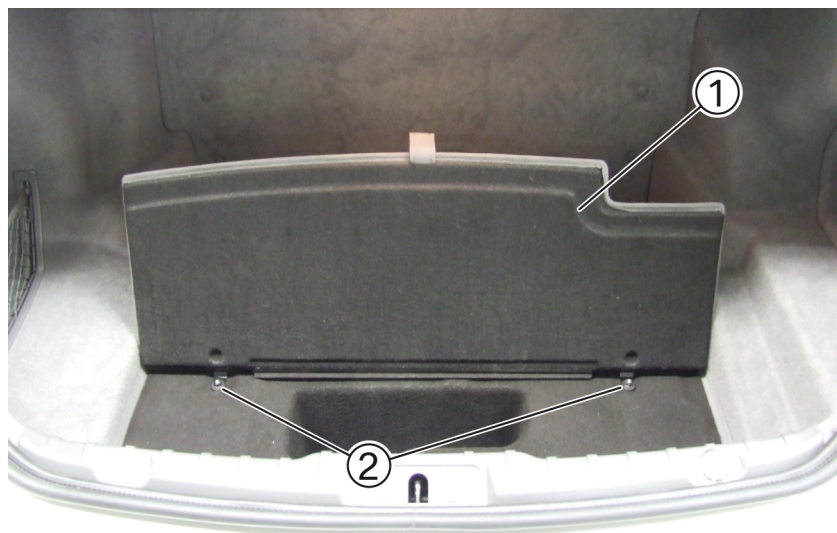

Loosen the nut (1) and pull off battery negative cable (2) upwards.

Cover the battery negative terminal to avoid contact with the battery negative cable.

The high-voltage battery pack is located under the luggage compartment trim panel.

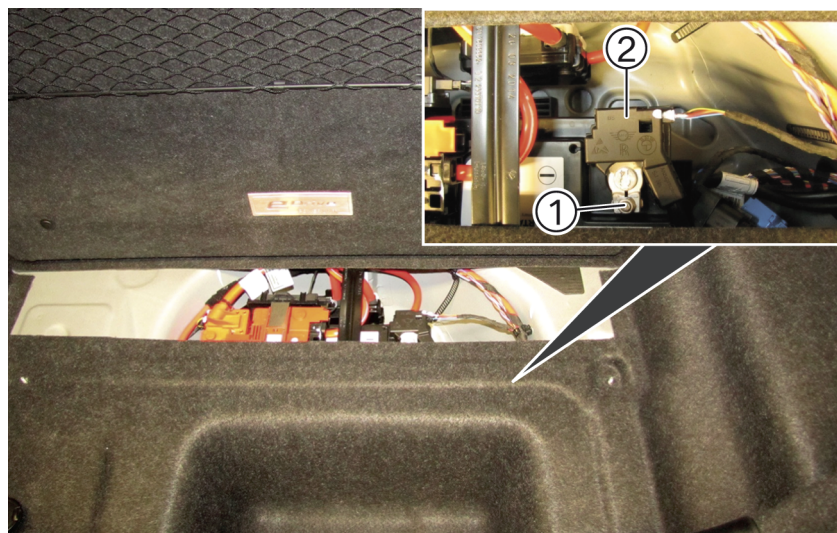

Labelling of the high-voltage battery pack:

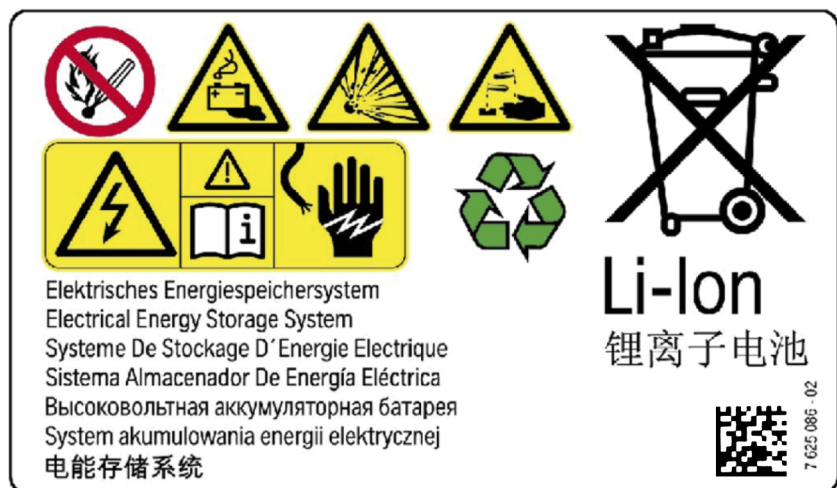

Labelling of the remaining high-voltage components:



Identification of the high-voltage cables (1) (insulation / orange sheath):

